



Electric toploaders

for ceramics up to 1320°C



Content

We at **Helmut ROHDE GmbH** dispose of more than 27 years of experience in manufacturing kilns and machinery for processing and firing of ceramics. Our product range has been extended by various kilns for heat treatment over the past years.

Among our customers range potteries and ceramic workshops, artists, schools and universities, public facilities as well as

research institutes and industrial manufacturers. With the help of a network of qualified specialised retailers we supply the entire European market and guarantee individual solutions and excellent local service.

This catalogue will give you an overview on our extensive product range of toploader and hood kiln models offered by Helmut ROHDE GmbH.



Toploaders Ecotop series up to 1320°C

3



Toploader details

4 – 5



Studio toploaders TE-MCC[®] series up to 1320°C

6 – 7



Professional toploaders TE-S series up to 1320°C

8 – 9



Hood kilns · Toploaders TE-Q and BT series

10 – 11



Toploader overview · Control units

12

NEW!
ecotop
**SAFE.
 EFFICIENT.
 RELIABLE.**

Toploaders Ecotop series



The ECOTOP series is a newly designed and developed kiln model among our range of toploading kilns. ECOTOP kilns are most energy-saving kilns and are outstanding in their energy efficiency due to a new insulating concept.

The 3-layer insulation structure consists of a 15 mm high-quality, micro-porous back insulation which allows firing up to usual stoneware temperatures with a regular 230 volt supply (Schuko, German grounded plug, 3.6 kW).

Special features:

- Final temperature 1320°C granted with 3.6 kW/230 Volts for Ecotop 60
- 3-layer insulation body with Microtherm®
- Significant increase in energy efficiency, e.g. you can save up to 20% energy with an Ecotop 60 compared to a TE 60 MCC®
- Silent and wearless SSR with exterior cooling element
- Ergonomic working position due to ROHDE turnable kiln stand
- Comfortable and exact kiln controller TC 304 (standard equipment)

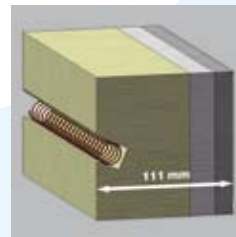
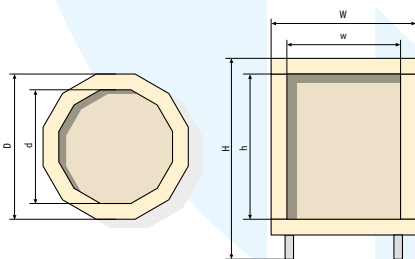

Please take a look at our valid pricelist for further special equipments.

Model	Tmax	Interior dimensions (mm)			Exterior dimensions (mm)			Output	Current	Plug	Furniture plates	Weight net
Volume	°C	w	d	h	W	D	H	kW	A		mm	kg
Ecotop 20	1320	ø 330	230		560	560	520	2,3	10,0	Schuko*	ø 310	42
Ecotop 43 L	1320	ø 400	340		650	700	630	2,9	13,0	Schuko*	ø 350	58
Ecotop 50	1320	ø 400	380		650	700	725	3,6	16,0	Schuko*	ø 350	58
Ecotop 50 S	1320	ø 400	380		650	700	725	4,5	6,5	CEE 16 A	ø 350	58
Ecotop 60 L	1200	ø 400	450		650	700	740	2,9	13,0	Schuko*	ø 350	60
Ecotop 60	1320	ø 400	450		650	700	740	3,6	16,0	Schuko*	ø 350	60
Ecotop 60 S	1320	ø 400	450		650	700	740	5,0	10,0	CEE 16 A	ø 350	60

*German grounded plug

Toploader details

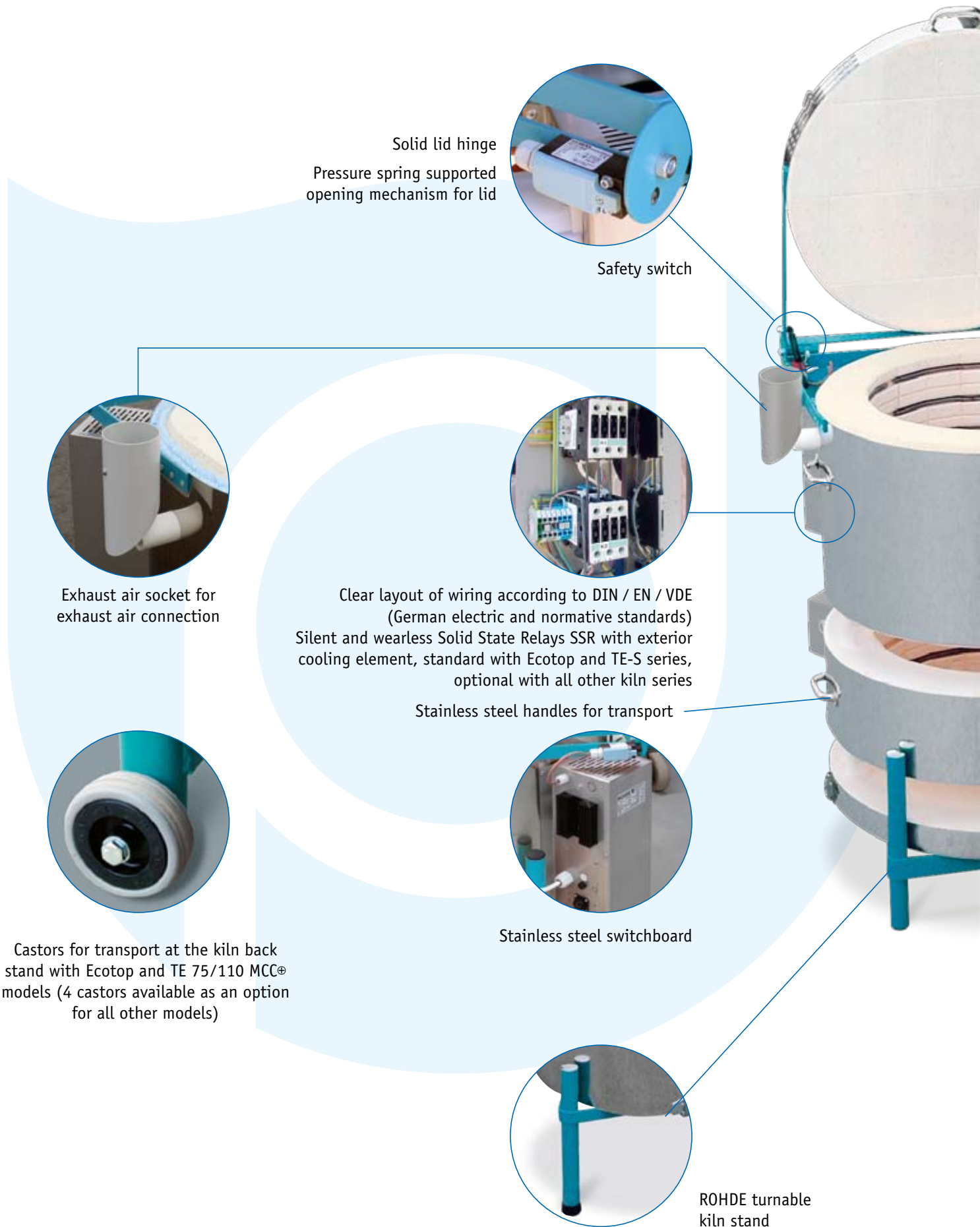

Solid lid, opens easily and widely



Firebricks are mechanically secured against displacement
Firebrick bevels prevent material from falling onto the goods

Lid firebricks joined mortar-free

Brick edges processed neatly
Heating elements fixed exactly



Thermocouple mounted in a safe position

Lid sealing can be adjusted and locked

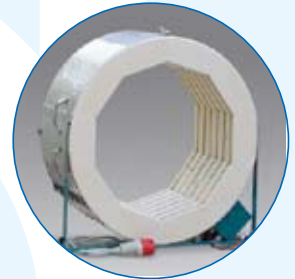

All models can be disassembled,
some can be extended
with a supplementary ring

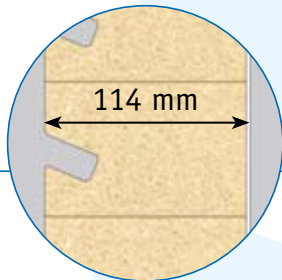

Wall structure professional
toploader TE-S series

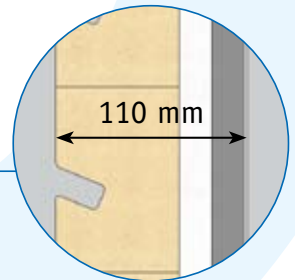

Wall structure ECOTOP
series, 3-layers

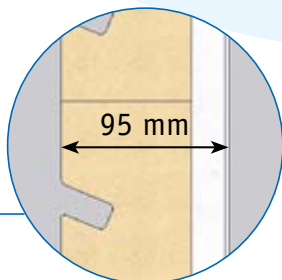

Wall structure studio
toploader TE-MCC⁺ series

Air supply handle
for all toplayer models

The TE-MCC⁺ toploader series

The solid TE-MCC⁺ kilns are suitable for many applications from glass processing at 600°C to stoneware at 1250°C.

This kiln series has been designed for applications in schools and kindergartens, as well as for artists and hobby workshops. The MCC⁺ series offers most possible flexibility for artistic applications with ceramics and glass due to its wide range of temperatures.

In addition to the extensive equipment and the high-quality workmanship of our toploaders we would also like to point out the following features:

Disassembly

All kiln models can be disassembled for transport into up to four compact pieces. All kiln parts are equipped with ergonomically designed devices for transport. It is possible to have the single parts transported to almost any desired location by only two persons. Even if you encounter a narrow passage, for a TE 300 a door width as little as 55 cm is sufficient.

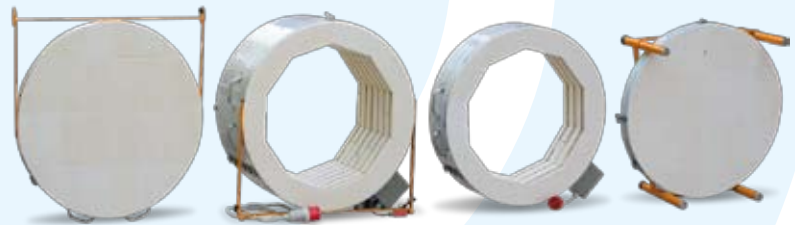

Extension

Four models of the TE-MCC⁺ series can be extended by 50% at any time by simply inserting a so-called supplementary ring (ZWR).



- TE 75 MCC⁺ can be extended to 110 litres
- TE 100 MCC⁺ can be extended to 150 litres
- TE 120 MCC⁺ can be extended to 180 litres
- TE 200 MCC⁺ can be extended to 300 litres

Insert the ring, plug in the kiln and continue working with 50% more space. **The kiln that meets your requirements at any time!**

Turnable kiln stand

After a safe delivery this ROHDE designed kiln stand enables you to adjust the toploader to an improved working height. It makes charging and emptying the firing chamber less strenuous for your back.

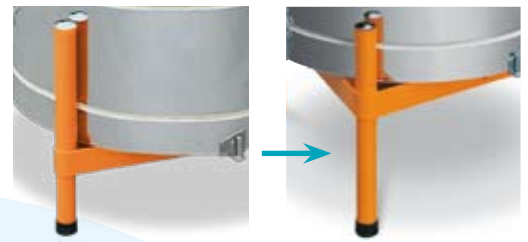

Optional equipment TE-MCC+ series

The models TE 75, TE 100, TE 120 und TE 200 MCC® can easily be equipped with a heated lid* (important for glass processing) – the heating elements are mounted on carrying rods (patented) which prevents parts falling from the lid onto goods.

* These can be extended by a supplementary ring. Please note that you can only operate the lid or the supplementary ring at any one time. It is also possible to retrofit the kiln with a heated lid.



Easy opening and closing of the lid due to pressure springs.

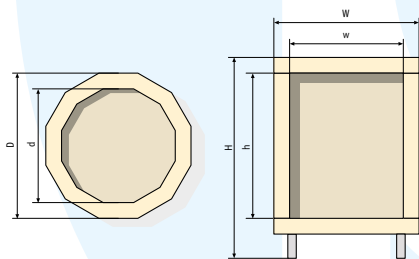

Extensive furniture set, optional for every kiln type.



Performance control with solid and wearless Solid State Relays with exterior cooling element (optional).



For further equipment options please consult our valid price list.

Model	Tmax	Interior dimensions (mm)			Exterior dimensions (mm)			Output	Current	Plug	Furniture plates	Weight
Volume	°C	w	d	h	W	D	H	kW	A		mm	net kg
TE 75 MCC®	1320	ø 470		460	720	740	800	6,0	13	CEE 16	ø 420	82
ZWR 75 MCC®		ø 470		230	650	700	230	3,0	-	-	-	20
TE 110 MCC®	1320	ø 470		690	720	740	1030	9,0	13	CEE 16	ø 420	105
TE 100 MCC®	1320	ø 520		460	800	830	800	7,0	15	CEE 16	ø 470	89
ZWR 100 MCC®		ø 520		230	800	830	230	3,5	-	-	-	25
TE 150 MCC®	1320	ø 520		690	800	830	1030	10,5	15	CEE 16	ø 470	109
TE 130 MCC®	1320	ø 590		460	830	880	800	7,3	16	CEE 16	ø 550	106
ZWR 130 MCC®		ø 590		230	830	880	230	3,7	-	-	-	35
TE 190 MCC®	1320	ø 590		690	830	880	1030	11,0	16	CEE 16	ø 550	125
TE 200 MCC®	1320	ø 740		460	1000	1050	800	9,2	20	CEE 32	special	130
ZWR 200 MCC®		ø 740		230	1000	1050	230	4,6	-	-	-	40
TE 300 MCC®	1320	ø 740		690	1000	1050	1030	13,8	20	CEE 32	special	170

ZWR = supplementary ring

Please ask for special voltage electric supply within EU.

The TE-S toploader series

The toploaders TE-S series are high-quality kilns for every-day applications in professional ceramic workshops.

We have consequently been improving this kiln series over the past 27 years – it combines state-of-the-art technology with high durability.

Many ceramic workshops have already approved of the flexible extension of many kiln models for extending their firing capacities economically.

In addition to the extensive equipment and the high-quality workmanship of our toploaders TE-S we would also like to point out the following features:

Extension

Four models of TE-S series can be extended by 50% at any time by simply inserting a so-called supplementary ring (ZWR).



- TE 80 S can be extended to 100 litres
- TE 95 S can be extended to 145 litres
- TE 130 S can be extended to 200 litres
- TE 165 S can be extended to 250 litres

Insert the ring, plug in the kiln and continue working with 50% more space.
The kiln that meets your requirements at any time!

Turnable kiln stand

After a safe delivery this ROHDE designed kiln stand enables you to adjust the toploader to an improved working height. It makes charging and emptying the firing chamber less strenuous for your back.

Disassembly

All kiln models can be disassembled for transport into up to four compact pieces. Even if you encounter a narrow passage, a door width as little as 55 cm is sufficient.

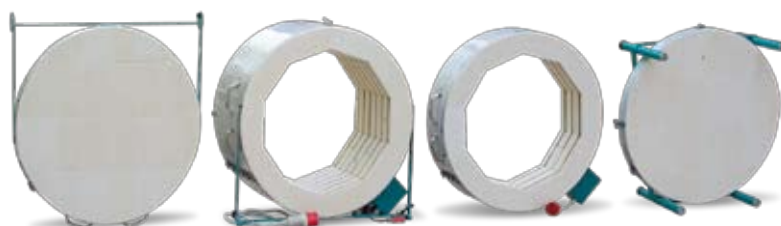

New – Solid State Relays

Solid State Relays control the performance of all kilns TE-S series. They are silent and almost wearless as no mechanic parts are involved. The cooling element is mounted outside the switchbox and cools these high-performance components. The switchbox is not heated up additionally and a long-lasting and trouble-free operation is guaranteed.



Optional equipment TE-MCC+ series



The floor heating allows for an optimum of equally distributed temperature in the lower and middle part of the kiln body. All kiln models as of TE 80 S can be equipped with a floor heating.

Extensive furniture set, optional for every kiln type.



Solid and retrofittable castors make the kiln flexible in every workshop.

The multi-zone control allows highest possible reproducibility.

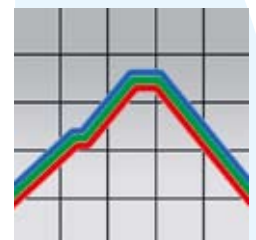

For further equipment options please consult our valid price list.

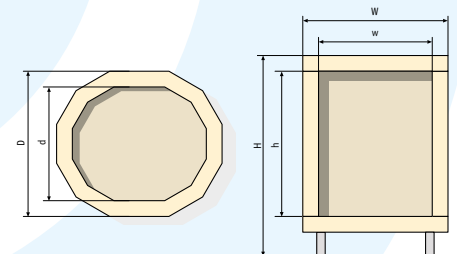

Model	Tmax	Interior dimensions (mm)			Exterior dimensions (mm)			Output	Current	Plug	Furniture plates	Weight net
Volume	°C	w	d	h	W	D	H	kW	A		mm	kg
TE 80 S	1320	ø 450		460	770	780	780	6,0	13	CEE 16	ø 420	99
ZWR 80 S		ø 450		150	770	780	150	3,0	-	-	-	20
TE 100 S	1320	ø 450		610	770	780	930	9,0	13	CEE 16	ø 420	117
TE 95 S	1320	ø 520		460	850	800	775	7,0	16	CEE 16	ø 470	113
ZWR 95 S		ø 520		230	850	800	230	3,5	-	-	-	20
TE 145 S	1320	ø 520		690	850	800	1000	10,5	16	CEE 16	ø 470	142
TE 130 S	1320	ø 610		460	950	950	770	8,8	19	CEE 32	ø 550	130
ZWR 130 S		ø 610		230	950	950	230	4,4	-	-	-	30
TE 200 S	1320	ø 610		690	950	950	1000	13,2	19	CEE 32	ø 550	166
TE 165 S	1320	730	630	460	1050	950	790	10,0	22	CEE 32	special	144
ZWR 165 S		730	630	230	1050	950	230	5,0	-	-	-	30
TE 250 S	1320	730	630	690	1050	950	1020	15,0	22	CEE 32	special	180
TE 300 S	1320	830	630	690	1160	950	1020	15,0	22	CEE 32	special	204

ZWR = supplementary ring

Please ask for special voltage electric supply within EU.

Hood kilns HE series up to 1320°C



The HE hood kiln series

Our hood kilns are the logical further development derived from our top-loader TE-S series. We have developed this kiln series, because charging the kiln from above at some points meets its practical limitations.

With this kiln type you do not have to charge the kiln laboriously from the front or from above – the kiln is simply put over the goods from above like a hood. This is ideal for large individual pieces which can be positioned freely on the kiln floor.

This construction has also been designed to make charging the kiln a lot less strenuous for your back. The tried and tested and flexible ring system allows almost any shape – from pieces with a diameter up to 1.5 m to kilns with (almost) any interior height.

There are no limits to your creativity! We supply you with the matching kiln.

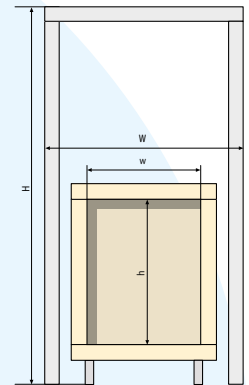
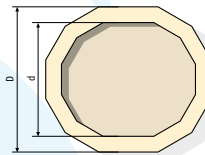

Standard equipment for HE series hood kilns



Smooth running winch for safe and easy lifting of the kiln hood.



Simply move the floor with a fork lift for highest accessibility when charging the kiln with ceramic goods.

Special equipment for HE series hood kilns



Hydraulic device for moving the hood facilitates operation.



Kiln floor on rails allows safe charging with large parts.

For further equipment options please consult our valid price list.

Model	Tmax °C	Interior dimensions (mm)			Exterior dimensions (mm)			Output kW	Current A	Plug	Furniture plates mm	Weight net kg	
		w	d	h	W	D	H						
HE 200	1320	∅ 610		680	920	1200	1800	13	19	-	CEE 32 / 63	∅ 550	235
HE 260	1320	∅ 610		900	920	1200	2200	18	25	-	CEE 32 / -	∅ 550	270
HE 250	1320	630	730	680	950	1250	1800	15	22	-	CEE 32 / -	special	270
HE 330	1320	630	730	900	950	1250	2200	20	29	-	CEE 32 / -	special	310
HE 300	1320	630	830	680	950	1350	1800	17	24	-	CEE 32 / -	special	300
HE 400	1320	630	830	900	950	1350	2200	22	32	-	CEE 32 / -	special	340

Please ask for special voltage electric supply within EU.



Toploader TE 70 QT

The Quattro TE-Q series

The Quattro series has two designs: 1. The TE-QN and the TE-QS are square toploaders with 4-sided heating and heating elements recessed into firebricks. 2. The models TE 70 QT and QTS are also equipped with 4-sided heating but heating elements are mounted on carrying rods. Both series have a high-quality 2-layer insulation structure which is accurately fitted into a durable rectangular kiln frame. For an appealing design of the frame we use a high-quality industrial lacquer in two colours. A good in-frame ventilation of the lid and galvanized sheet metal for the kiln casing protects the kiln efficiently against corrosion. Another special feature is the carefully processed kiln lid which is particularly easy to open and supported by pressure springs - the same principle as with our round toploaders.



Easy opening and closing of lid with pressure springs.

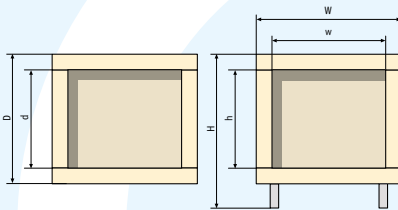

Floor covered with SIC plates, durable and heat permeable.

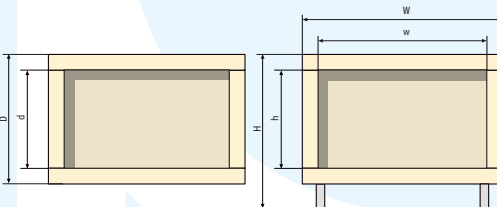

Toploader BT 500

The BT series

Our BT kilns are unique on the German market and unfortunately not very common in use. They combine the construction of a frontloading kiln and the 5-sided heating with the advantages of a toploader. The high-quality insulation and the very even distribution of heat make the BT suitable for workshops in which the kiln has to be charged densely with a great variety of ceramic goods. The excellent overview from above is very helpful. **You won't want to swap your BT with a frontloader!**

Model	Tmax °C	Interior dimensions (mm)			Exterior dimensions (mm)			Output kW	Current A	Plug	Furniture plates mm	Weight net kg
		w	d	h	W	D	H					
TE 10 Q	1320	230	180	230	430	560	540	2,0	- 9	Schuko*	200 x 150	30
TE 35 Q	1320	380	380	230	620	750	540	3,6	- 16	Schuko*	370 x 340	81
TE 50 QN	1320	380	380	340	620	750	650	3,6	- 16	Schuko*	370 x 340	100
TE 50 QS	1320	380	380	340	620	750	650	5,0	11 22	CEE 16	370 x 340	100
TE 70 QT	1250	410	410	420	690	800	760	3,6	- 16	Schuko*	350 x 350	145
TE 70 QT-S	1320	410	410	420	690	800	760	6,0	13 26	CEE 16	350 x 350	150
TE 110 QT	1320	450	450	530	760	850	900	9,0	13 40	CEE 16	400 x 400	250
BT 300	1320	920	570	610	1200	920	1110	15,0	22 -	CEE 63	500 x 400	400
BT 500	1320	1150	650	690	1430	1000	1190	24,0	35 -	CEE 63	600 x 500	535

*German grounded plug

Please ask for special voltage electric supply within EU.

	Ecotop	TE-MCC®	TE-S	HE	TE-Q N/S	TE-QT	BT
Final temperature	*1320°	1320°	1320°	1320°	1320°	*1320°	1320°
Heating from all sides	•	•	•	•	•	•	•
Floor heating	–	–	○	○	–	–	•
Lid heating	○	○	–	–	–	–	–
Solid State Relays	•	○	•	○	○	○	○
Elements recessed into firebricks	•	•	•	•	•	–	•
Elements mounted on carrying rods	–	–	–	–	–	•	–
Convenient turnable foot stand	•	•	•	–	–	–	–
Exhaust air socket	•	•	•	•	•	•	•
Air supply handle	•	•	•	•	–	–	–
Can be disassembled for transport	•	•	•	•	–	–	○
Extension available	–	•	•	–	–	–	–
3 years guarantee	•	•	•	•	•	•	•
CE conformity	•	•	•	•	•	•	•
GS safety certificate	•	•	•	•	•	•	pending
Spyhole	○	○	○	○	○	○	○

• standard ○ optional – not available *for some models limited

Control units for toppers



Controller TC 304

Clearly structured controller and easy to operate, i.a. for hobby, simple workshop and school applications.

- 5 firing programs freely selectable
- Heating-up time programmable
- 1 dwell time

Standard controller.



Controller TC 504

Intuitive operating layout with extensive performance spectrum characterize this controller which has been developed especially for ROHDE GmbH.

- 10 firing programs freely selectable
- 2 dwell times programmable
- 2- resp. 3-zone control (optional)
- 1 additional switch output e.g. for exhaust air flap (optional)

Optional equipment.



Controller TC 507

This controller is outstanding with regards to greatest possible performance spectrum for almost every application.

- Up to 30 firing programs freely programmable
- Up to 80 semi segments
- 2- resp. 3-zone control (optional)
- 2 add. switch outputs (optional)

Optional equipment.

Your specialised retailer:

For more information please contact your specialised retailer, visit our homepage or contact us directly.

Helmut Rohde GmbH

Ried 9, D-83134 Prutting

Tel.: +49 (0)8036/674976-10, Fax: -19

e-Mail: info@rohde-online.net

Internet: www.rohde-brennofen.de

Technical changes and dimensional deviations in the course of further development reserved.